

 **CHANNEL VISION™**
10 Year Limited Warranty

Channel Vision Technology will repair or replace any defect in material or workmanship which occurs during normal use of this product with new or rebuilt parts, free of charge in the USA, for ten years from the date of original purchase. This is a no hassle warranty with no mail in warranty card needed. This warranty does not cover damages in shipment, failures caused by other products not supplied by Channel Vision Technology, or failures due to accident, misuse, abuse, or alteration of the equipment. This warranty is extended only to the original purchaser, and a purchase receipt, invoice, or other proof of original purchase date will be required before warranty repairs are provided.

Mail in service can be obtained during the warranty period by calling (800) 840-0288 toll free. A Return Authorization number must be obtained in advance and can be marked on the outside of the shipping carton.

This warranty gives you specific legal rights and you may have other rights (which vary from state to state). If a problem with this product develops during or after the warranty period, please contact Channel Vision Technology, your dealer or any factory-authorized service center.

 **CHANNEL VISION™**
channelvision.com

234 Fischer Avenue, Costa Mesa, California 92626
(714)424-6500 • (800)840-0288 • (714)424-6510 fax

500-152 rev B

INSTRUCTIONS

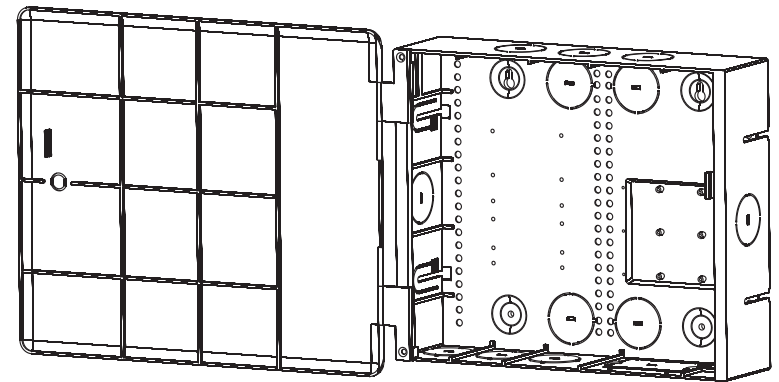

C-0113 **12" Structured Wiring Enclosure**

 **CHANNEL VISION™**
CENTRAL

©2006 CHANNEL VISION TECHNOLOGY

The **C-0113** is a 12" structured wiring enclosure which can be mounted between studs in a standard 2x4 wall or surface mounted to any finished wall. It is constructed of rigid plastic, making it both durable and lightweight. Innovative mounting slots on the C-0113 allow it to be installed and properly adjusted for the desired drywall depth in a less than a minute! The C-0113 is perfect for the installer looking for a cost-effective way to implement structured wiring.

Features:

- Hinged Cover
- Easy mounting slots
- Compatible with Channel Vision structured wiring modules
- Knockout for a standard junction box

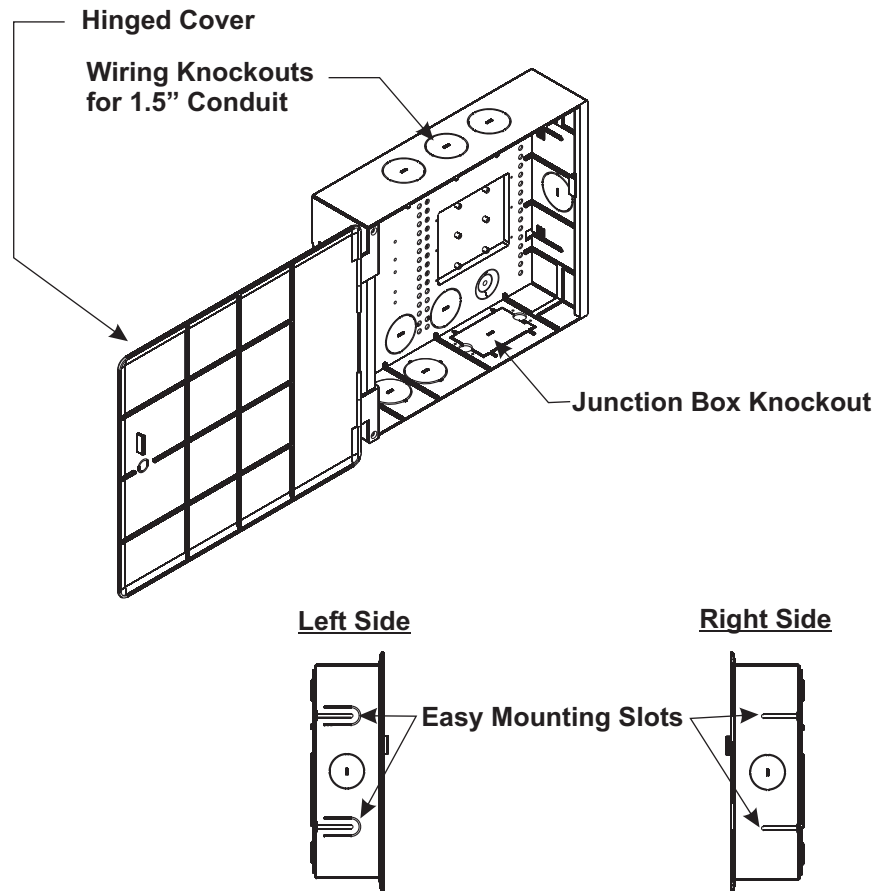

Typical Installation

At the desired height, place a drywall screw in the center of each stud. Do not screw them all the way in. Align the top two mounting slots with the screws and slide the enclosure into place.

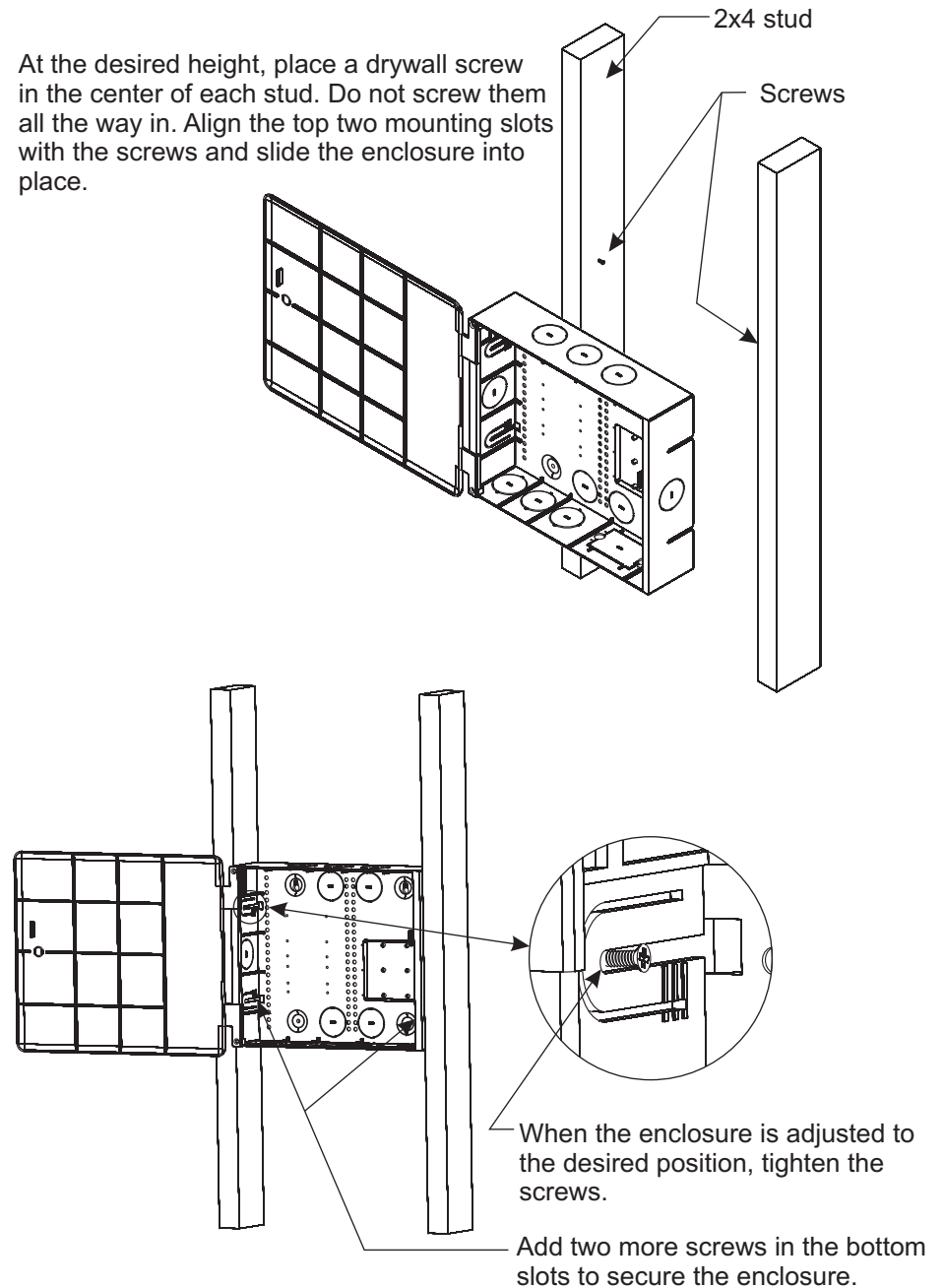

Note: This product is intended for indoor use only.